

6 WATCH TV

Change the channel you are watching by entering the three-digit channel number using the number buttons on the remote control. Or, you can press the **CH ^** or **CH v** buttons to step through the channels in order.

Press the **VOL +** and **VOL -** buttons to turn the volume up or down. You can turn off the sound altogether with the **MUTE** button. The sound comes back on when you press **MUTE** again.

When subtitles are available for a programme it is indicated by a **SUB** symbol in the browsing bar at the bottom of the screen when you change channels (press **i** at anytime whilst watching TV to display the bar). Press the **SUB** button to display the subtitles menu and use the **^** and **v** buttons to move the orange highlight bar to "English" if you want to turn on subtitles, or "Off" to turn off subtitles, and then press **OK**.

If audio description (a spoken description of the broadcast) is available for a programme it is indicated by an **AD** symbol in the browsing bar at the bottom of the screen. To turn on audio description, press the **AD** button to display the available audio menu and use the **^** and **v** buttons to move the orange highlight bar to "English Audio Description". Then press **OK**.

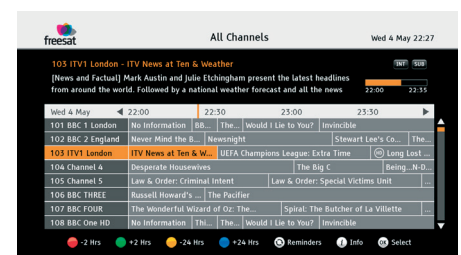

You can find out the programmes scheduled to be shown on all the Freesat channels up to eight days ahead using the **GUIDE** button. Press the button and then press **OK**. Browse the scheduled programmes using the **^** and **v** buttons to move through the channels and the **^** and **v** buttons to move the orange highlight bar to show the programmes showing at different times.

Press **OK** to switch to the programme highlighted by the orange bar. If the programme is on at the time, the receiver will switch to the correct channel immediately. If the programme is scheduled for later on, a reminder is set - when the programme is about to start, a message is displayed on screen and, after a few seconds, the receiver automatically switches to the necessary channel.

When you have finished with the programme guide, return to normal TV viewing by pressing **EXIT**.



Digital text and interactive services are available from some Freesat channels and you can use them by following the on-screen prompts and pressing **TEXT** or the **AD** button while watching the channel. This displays a menu of services available from that channel or broadcaster. When you have finished with the interactive services, return to normal TV viewing by pressing **EXIT**.

You can pause live TV by pressing the **PAUSE** button. Resume playback by pressing **PAUSE** again.

Record programmes to watch later by pressing the **RECORD** button.

Playback recordings by pressing the **LIBRARY** button, pressing the **^** and **v** buttons to select a recording and then pressing **OK**.

Switch off your receiver by pressing the **POWER** button, and press the button again to turn it on.

To find out more about live pause, recording and playing back programmes, and lots more, please refer to the main user guide.

POWER - switches the receiver on and off.

MUTE - silences the receiver's sound.

1-9 - 0, 1 ... 9 - enter channel numbers, numeric values in the set-up menus or a jump point in playback. Also enters your postcode during the installation process.

VOL + Turns the volume up and **VOL -** down.

CH ^ Switches to the next or **CH v** previous channel. Moves one page up or down in the channel list and programme guide.

EXIT Exits a menu and returns to normal TV viewing.

RED, GREEN, YELLOW, BLUE - Red, green, yellow, blue - Chooses options within menus.

GUIDE Displays the programme guide.

i Displays channel and programme information.

UP, DOWN, LEFT, RIGHT - move the highlight bar in menus and in the programme guide, and allow you to browse the channels and programmes.

OK Selects the highlighted option in a menu.

LIBRARY Displays the list of programmes already recorded and set to be recorded.

BACK Exits a menu and returns to the previous menu.

Manhattan

Plaza HDR•S Remote Control

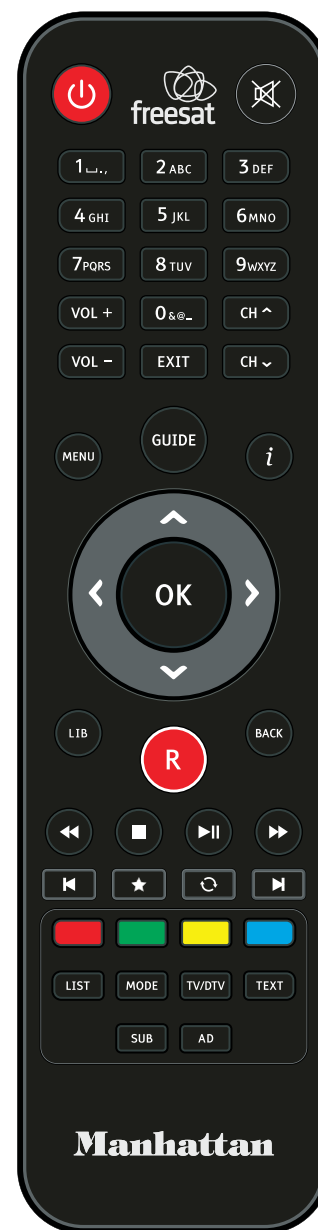

REVERSE / **FAST FORWARD** - Winds backwards or forwards through a recording being played. Moves through the programme guide in 2 hour steps.

STOP - Stops playback of a recorded programme. Returns to live TV from paused live TV.

PAUSE - Pauses live TV. Starts and stops playback of a recorded programme or paused live TV.

REVERSE / **FAST FORWARD** - Jumps backwards or forwards through a recording being played. Moves through the programme guide in 24 hour steps.

RECORD - Records the selected programme.

MENU - Displays the main menu screen.

STAR - Selects favourite channels sequentially whilst watching TV and adds favourite channels to the channel list.

LIST - Displays the channel list.

MODE - Switches between available screen display modes.

REVERSE - Switches back to the last channel watched.

TV/DTV - Switches the TV SCART output between Freesat and the TV's tuner.

AD - Displays the available audio menu used to change between different soundtracks (such as languages and audio description).

SUB - Displays the subtitles menu used to select subtitles.

TEXT - Displays interactive and digital text services (where available).

FREE TV IN JUST A JIFFY

YOUR QUICK START GUIDE

Manhattan
Model: Plaza HDR+S 500GB

For assistance, please call the Manhattan helpline on **020 8450 0005** or visit our website at www.manhattan-tv.com

Find out more about Freesat at www.freesat.co.uk
Join in at community.freesat.co.uk
Follow Freesat on www.twitter.com/freesat_TV
Like Freesat on www.facebook.com/freesat



Plaza HDR•S receiver



HDMI cable to connect to an HD-ready TV



Power supply



Batteries for the remote control



Remote control

UNPACK

Unpack and check the contents of your Manhattan Plaza HDR•S Freesat+ receiver pack:



Quick Start Guide

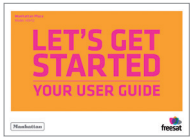

Main User Guide

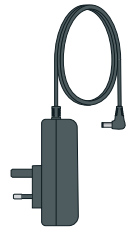

Power supply

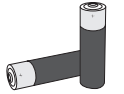

Batteries for the remote control



Remote control

Manhattan



2 CONNECT TO A DISH

To receive Freesat you must connect your Plaza HDR•S receiver to an appropriate satellite dish, fixed in position and accurately pointed at 28.2° East satellite position.

For safety reasons and to provide reliable reception, we strongly recommend that the dish is professionally installed. If you have any questions about the dish, please consult your installer.

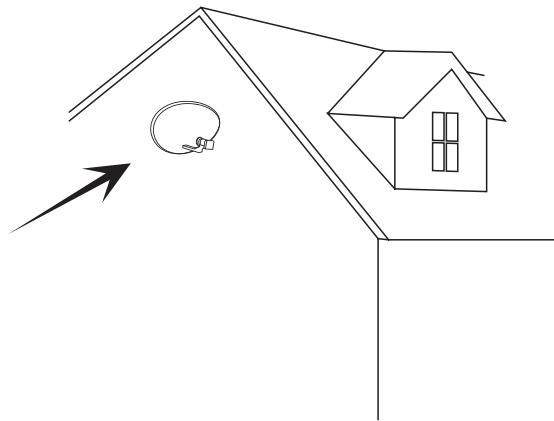

3 PLUG IN

Place your Plaza HDR•S receiver on a firm, level surface close to your television, a mains electricity socket, and the cables from the dish.

Connect the cables from your dish to the LNB IN 1 and LNB IN 2 sockets at the back of the receiver.

Make sure your television is turned off and connect the HDMI cable to the HDMI socket on the rear of the Plaza HDR•S and to an HDMI socket on your television. If you need more guidance, check your television manual.

Connect the +12V DC connector to the 3A DC 12V connector at the back of the receiver. Then connect the Power Supply Unit (unit with 3 pin mains plug) to an available mains socket that is turned off.

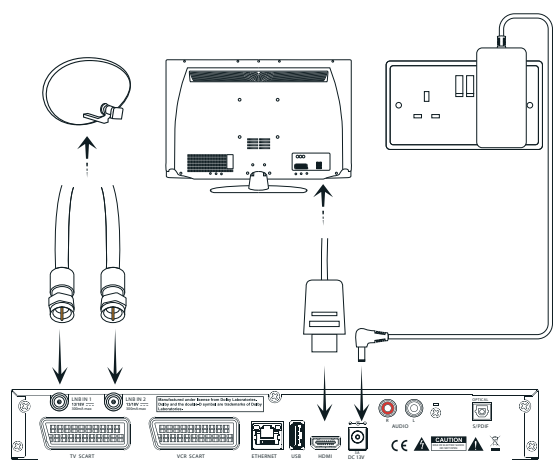

To watch On Demand TV services including BBC iPlayer and ITV Player, the Plaza HDR•S must be connected to your internet router or hub using an ethernet cable (not supplied). Plug one end of the ethernet cable into the ETHERNET socket at the back of the Plaza HDR•S, and the other into your hub or router. Make sure the connections are fully pushed in - you'll hear a click as they lock into place. Consult your router or hub's documentation for further guidance.

4 SWITCH ON

Remove the battery compartment cover from the back of the Plaza HDR•S remote control by lifting the cover catch. Insert the two AAA batteries supplied, as shown on the inside of the compartment. Replace the compartment cover.

Turn on your TV set and choose the HDMI input (see your television manual).

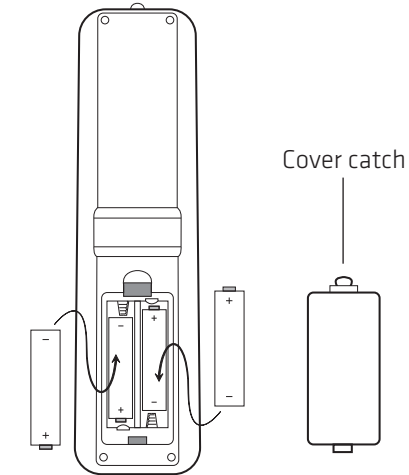

Switch on the mains socket the Plaza HDR•S is connected to. After a few seconds, step one of the Freesat installation process will be shown on the television screen.

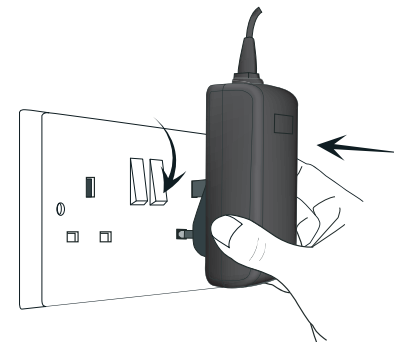

If you do not see this screen (pictured opposite), please refer to the Troubleshooting section in the main user guide.



5 TUNE IN

When the first installation screen is displayed, use the ⏪ or ⏩ buttons to select the screen format of your television (16:9 Widescreen or the squarer 4:3 Traditional). Press the OK button to highlight the HDMI Resolution selection box, and then use the ⏪ or ⏩ buttons to select the correct resolution for your television (see your television's manual for guidance, or select 720p if unsure).

Press the OK button to highlight the "Next" box and then press OK again to display the next installation step.

The signal check is successful when both LNB inputs are receiving a valid signal. If it fails, please see the Troubleshooting section in the main user guide. When the first input is connected to a valid signal, the "Next" box will become highlighted. Press OK to display the next step.

Enter your postcode, pressing the number buttons an appropriate number of times to produce the letters (printed above each button) and numbers required, in the same way as 'texting' on a mobile phone. You do not need to enter a space. If you make a mistake, the ⏪ button deletes the previous character. Press OK to confirm the postcode and then press it again to display the next step.

Your Plaza HDR•S receiver will take a couple of minutes to find and store the Freesat channels available, displaying the total number of Freesat TV and radio channels found. Press the OK button to display the next step.

Enter your choice of PIN (used to unlock certain channels and functions) by pressing the required number button (0, 1 ... 9) for each of the four PIN digits. Press OK to display the next step.

Setup is now complete. Your PIN will be displayed on-screen along with a reminder to take a note of it. When ready, press OK and enjoy watching Freesat TV.

